

REFER TO SHEET 1 (COVER SHEET) FOR ALL BUILDING INFORMATION REGARDING:

- SUSTAINABILITY REQUIREMENTS
- SITE CLASSIFICATION
- GENERAL BUILDING INFORMATION

ALL MECHANICAL VENTILATION TO BE DISCHARGED TO OUTDOOR AIR AS PER NCC 2022 REQUIREMENTS

FIRE RESISTANT PLASTERBOARD TO BE INSTALLED BEHIND COOKTOP

ALL EXTERIOR STEPS AND LANDINGS BY BUILDER UNLESS NOTED OTHERWISE

ALL GROUND FLOOR BULKHEAD AND SQUARE SET OPENING FRAMES TO BE 2155 ABOVE FFL UNLESS NOTED OTHERWISE

ALL GROUND FLOOR INTERNAL DOORS TO BE 2040 HIGH UNLESS NOTED OTHERWISE

REFER TO WINDOW AND DOOR SCHEDULES FOR FULL DETAILS OF ALL WINDOWS AND DOORS. PLEASE NOTE WINDOW AND DOOR SIZES ARE BASED ON MANUFACTURERS SPECIFICATIONS AT DEPOSIT STAGE AND MAY DIFFER SLIGHTLY TO THE SIZES NOMINATED IN THE SCOPE OF WORKS DUE TO MANUFACTURING CHANGES AT THE TIME OF CONSTRUCTION.

FINAL WINDOW AND EXTERIOR DOOR LOCATIONS MAY BE ADJUSTED ON SITE TO SUIT BRICKWORK GAUGE

ALL STAIR TREADS TO PROVIDE A MINIMUM SLIP RESISTANCE TO MEET NCC 2022 REQUIREMENTS

UNLESS NOTED OTHERWISE ALL ROOMS ARE REFERENCED AS FOLLOWS:



LEGEND

HS / WS	HOB SPOUT / WALL SPOUT
	FACE BRICK / COMMON BRICK
	HEBEL
	SOUND INSULATION
AJ	BRICK ARTICULATION JOINT
SDP	STANDARD DOWNSPIPE
CDP	CHARGED DOWNSPIPE
	EXHAUST FAN
L.B.W	LOAD BEARING WALL
	THIS DOOR OPENS FIRST
	INTERCONNECTED SMOKE ALARM
# UC	LIFT OFF HINGE / UNDERCUT
+	WATER POINT
WP	FRIDGE WATER POINT
GAS	GAS BAYONET

PROVIDE AND INSTALL 3 PHASE REVERSE CYCLE AIR CONDITIONING SYSTEM. NUMBER AND POSITIONING OF OUTLETS AND THE FINAL LOCATION OF THE RETURN AIR GRILLE WILL BE DETERMINED ON SITE BY THE AIR CONDITIONING CONTRACTOR AND IS SUBJECT TO TRUSS LAYOUT AND ANY OTHER CONSTRUCTION CONSTRAINTS.

FRAME MANUFACTURER TO PROVIDE CLEARANCE FOR PASSAGE OF FAN COIL UNIT FROM RETURN AIR OPENING TO FINAL FAN COIL LOCATION.

ANY PART OF THE FASCIA, GUTTERING OR DOWNSPIPE THAT IS WITHIN 450mm OF ANY BOUNDARY IS TO BE NON-COMBUSTIBLE IN ACCORDANCE WITH NCC 2022

ALL EXTERIOR SLABS TO BE GRADED BY CONCRETER TO ACHIEVE APPROX. 1:100 FALL TO OUTSIDE EDGE WITH MAXIMUM CROSSFALL OF 30mm OVER ENTIRE SLAB.

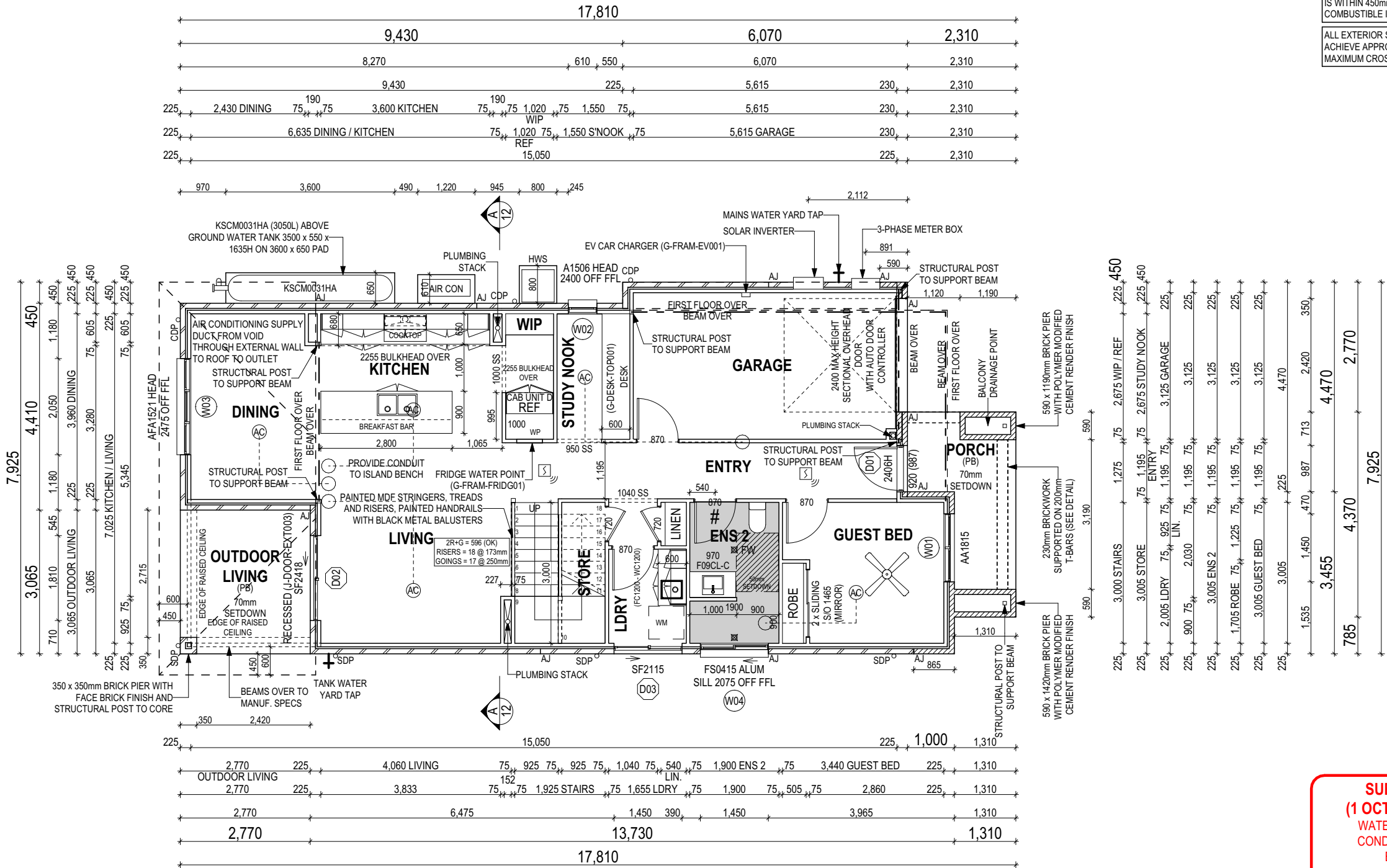

SUBJECT TO NCC 2022
(1 OCT 2023 + 7 STAR BASIX)
WATERPROOFING & PLUMBING
CONDENSATION MANAGEMENT
ENERGY EFFICIENCY
LIVABLE HOUSING

PLAN ACCEPTANCE BY OWNER

SIGNATURE: _____ DATE: _____

SIGNATURE: _____ DATE: _____

PLEASE NOTE THAT VARIATIONS WILL NOT BE ACCEPTED AFTER THIS PLAN ACCEPTANCE HAS BEEN SIGNED

ALL DIMENSIONS ARE FRAME DIMENSIONS

© 2025 MOJO HOMES PTY LTD (ABN 31 166 754 696). THIS DRAWING IS AN ORIGINAL ARTISTIC WORK WITHIN THE MEANING OF THE COPYRIGHT ACT 1968 (CTH). MOJO HOMES PTY LTD IS THE OWNER OF COPYRIGHT IN THIS DRAWING. YOU HEREBY AGREE AND UNDERTAKE THAT YOU WILL NOT IN ANY WAY REPRODUCE, COPY, MODIFY, USE OR TAKE ADVANTAGE OF THE DRAWING TO BUILD A HOUSE BASED ON THIS PLAN (WHETHER IN WHOLE OR IN PART) WITHOUT THE PRIOR WRITTEN CONSENT OF MOJO HOMES PTY LTD.

MOJO
HOMES

SPECIFICATION:		REVISION	DRAWN	CLIENT:		HOUSE DESIGN:		HOUSE CODE:	DO NOT SCALE DRAWINGS. USE FIGURED DIMENSIONS ONLY. CHECK AND VERIFY DIMENSIONS AND LEVELS PRIOR TO THE COMMENCEMENT OF ANY WORK. ALL DISCREPANCIES TO BE REPORTED TO THE DRAFTING OFFICE.
M-SERIES	4	COLOURS APPLIED	ENG 20/02/2025	N.S.W EXTENSIONS PTY LTD & EDWARD J FITZPATRICK		LIDO 25		H-JMSLDO40DA	
COPYRIGHT:	5	WORKING DRAWINGS CHECK	GBO 09/04/2025	ADDRESS:		FACADE DESIGN:		FACADE CODE:	
© 2025	6	COUNCIL REQUIREMENT AMENDMENT	GBO 05/05/2025	22 PYRAMID AVE, PADSTOW NSW 2211		CUSTOM		F-JMSLDO40CSTM01	
	7	AMENDED AS PER PCV007	LCS 26/05/2025	LOT / SECTION / DP:	COUNCIL:	SHEET TITLE:	SHEET No.:	SCALES:	
	8	AMENDED AS PER PCV008 & PCV009	GBO 18/05/2025	113 / - / 16258	CANTERBURY BANKSTOWN COUNCIL	GROUND FLOOR PLAN	7 / 29	1:100	652354

REFER TO SHEET 1 (COVER SHEET) FOR ALL BUILDING INFORMATION REGARDING:

- SUSTAINABILITY REQUIREMENTS
- SITE CLASSIFICATION
- GENERAL BUILDING INFORMATION

ALL MECHANICAL VENTILATION TO BE DISCHARGED TO OUTDOOR AIR AS PER NCC 2022 REQUIREMENTS

FIRE RESISTANT PLASTERBOARD TO BE INSTALLED BEHIND COOKTOP

ALL EXTERIOR STEPS AND LANDINGS BY BUILDER UNLESS NOTED OTHERWISE

ALL FIRST FLOOR BULKHEAD AND SQUARE SET OPENING FRAMES TO BE 2155 ABOVE FFL UNLESS NOTED OTHERWISE

ALL FIRST FLOOR INTERNAL DOORS TO BE 2040 HIGH UNLESS NOTED OTHERWISE

REFER TO WINDOW AND DOOR SCHEDULES FOR FULL DETAILS OF ALL WINDOWS AND DOORS. PLEASE NOTE WINDOW AND DOOR SIZES ARE BASED ON MANUFACTURERS SPECIFICATIONS AT DEPOSIT STAGE AND MAY DIFFER SLIGHTLY TO THE SIZES NOMINATED IN THE SCOPE OF WORKS DUE TO MANUFACTURING CHANGES AT THE TIME OF CONSTRUCTION.

FINAL WINDOW AND EXTERIOR DOOR LOCATIONS MAY BE ADJUSTED ON SITE TO SUIT BRICKWORK GAUGE

ALL STAIR TREADS TO PROVIDE A MINIMUM SLIP RESISTANCE TO MEET NCC 2022 REQUIREMENTS

FIRST FLOOR WINDOW OPENINGS TO BE RESTRICTED AS REQUIRED BY THE NCC 2022

PROVIDE FLOOR WASTE AND OVERFLOW SPITTERS TO UPPER FLOOR TANKED BALCONIES WHERE APPLICABLE AS PER:

- G-FACA-BALC02 (PFC/BRICKWORK)
- G-FRAM-BALC01 (LIGHTWEIGHT CLADDING)

UNLESS NOTED OTHERWISE ALL ROOMS ARE REFERENCED AS FOLLOWS:



LEGEND

- HS / WS HOB SPOUT / WALL SPOUT
- FACE BRICK / COMMON BRICK
- HEBEL
- SOUND INSULATION
- AJ BRICK ARTICULATION JOINT
- SDP STANDARD DOWNPIPE
- CDP CHARGED DOWNPIPE
- EXHAUST FAN
- L.B.W LOAD BEARING WALL
- THIS DOOR OPENS FIRST
- INTERCONNECTED SMOKE ALARM
- # UC LIFT OFF HINGE / UNDERCUT
- WATER POINT
- WP FRIDGE WATER POINT
- GAS GAS BAYONET

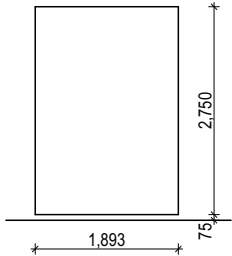

STAIR VOID DETAIL
SCALE: 1:100

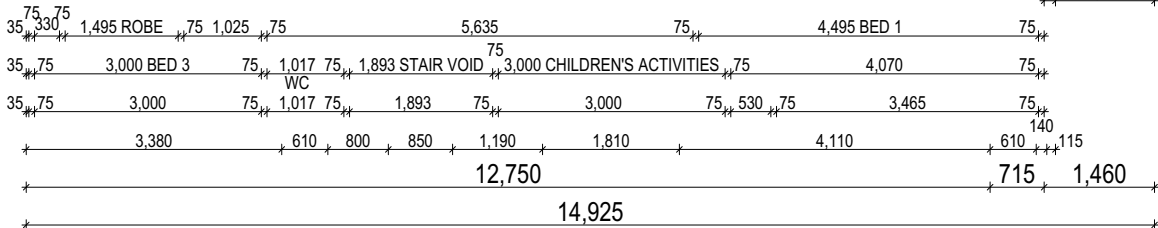
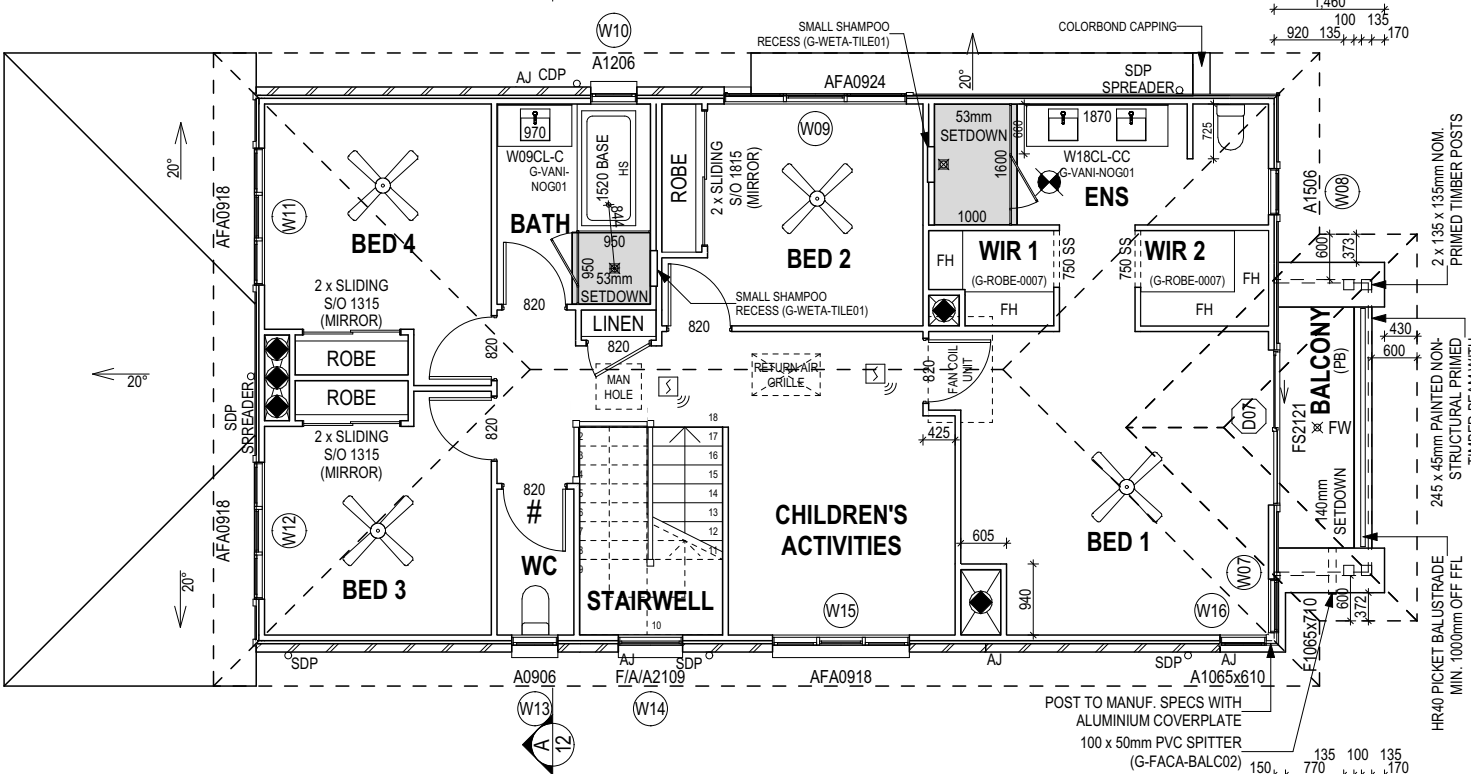
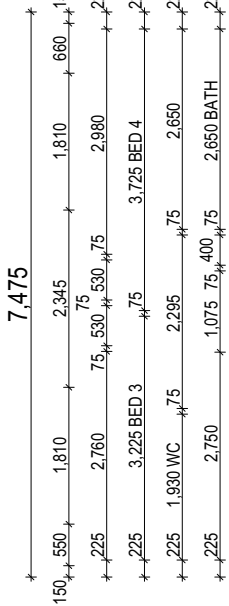

ALL DIMENSIONS ARE FRAME DIMENSIONS

© 2025 MOJO HOMES PTY LTD (ABN 31 166 754 696). THIS DRAWING IS AN ORIGINAL ARTISTIC WORK WITHIN THE MEANING OF THE COPYRIGHT ACT 1968 (CTH). MOJO HOMES PTY LTD IS THE OWNER OF COPYRIGHT IN THIS DRAWING. YOU HEREBY AGREE AND UNDERTAKE THAT YOU WILL NOT IN ANY WAY REPRODUCE, COPY, MODIFY, USE OR TAKE ADVANTAGE OF THE DRAWING TO BUILD A HOUSE BASED ON THIS PLAN (WHETHER IN WHOLE OR IN PART) WITHOUT THE PRIOR WRITTEN CONSENT OF MOJO HOMES PTY LTD.

PROVIDE AND INSTALL 3 PHASE REVERSE CYCLE AIR CONDITIONING SYSTEM. NUMBER AND POSITIONING OF OUTLETS AND THE FINAL LOCATION OF THE RETURN AIR GRILLE WILL BE DETERMINED ON SITE BY THE AIR CONDITIONING CONTRACTOR AND IS SUBJECT TO TRUSS LAYOUT AND ANY OTHER CONSTRUCTION CONSTRAINTS.

FRAME MANUFACTURER TO PROVIDE CLEARANCE FOR PASSAGE OF FAN COIL UNIT FROM RETURN AIR OPENING TO FINAL FAN COIL LOCATION.

ANY PART OF THE FASCIA, GUTTERING OR DOWNPIPE THAT IS WITHIN 450mm OF ANY BOUNDARY IS TO BE NON-COMBUSTIBLE IN ACCORDANCE WITH NCC 2022

ALL EXTERIOR SLABS TO BE GRADED BY CONCRETER TO ACHIEVE APPROX. 1:100 FALL TO OUTSIDE EDGE WITH MAXIMUM CROSSFALL OF 30mm OVER ENTIRE SLAB.

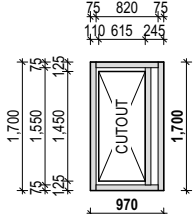

BATH HOB DETAIL
1520 BASE
FRAME 530 HIGH

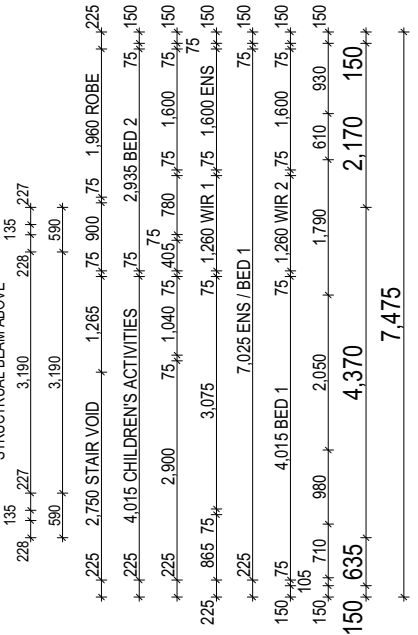

**SUBJECT TO NCC 2022
(1 OCT 2023 + 7 STAR BASIX)**
WATERPROOFING & PLUMBING
CONDENSATION MANAGEMENT
ENERGY EFFICIENCY
LIVABLE HOUSING

PLAN ACCEPTANCE BY OWNER

SIGNATURE: DATE:

SIGNATURE: DATE:

PLEASE NOTE THAT VARIATIONS WILL NOT BE ACCEPTED AFTER THIS PLAN ACCEPTANCE HAS BEEN SIGNED

MOJO
HOMES

SPECIFICATION:
M-SERIES

COPYRIGHT:
© 2025

REVISION

4

COLOURS APPLIED

ENG

20/02/2025

5

WORKING DRAWINGS CHECK

GBO

09/04/2025

6

COUNCIL REQUIREMENT AMENDMENT

GBO

05/05/2025

7

AMENDED AS PER PCV007

LCS

26/05/2025

8

AMENDED AS PER PCV008 & PCV009

GBO

18/05/2025

DRAWN

ENG

20/02/2025

GBO

09/04/2025

GBO

05/05/2025

LCS

26/05/2025

GBO

18/05/2025

CLIENT:

N.S.W

EXTENSIONS PTY LTD & EDWARD J FITZPATRICK

ADDRESS:

22 PYRAMID AVE, PADSTOW NSW 2211

LOT / SECTION / DP:

113 / - / 16258

COUNCIL:

CANTERBURY BANKSTOWN COUNCIL

HOUSE DESIGN:

LIDO 25

FACADE DESIGN:

CUSTOM

SHEET TITLE:

FIRST FLOOR PLAN

HOUSE CODE:

H-JMSLDO40DA

FACADE CODE:

F-JMSLDO40CSTM01

SHEET No.:

8 / 29

SCALES:

1:100

DO NOT SCALE DRAWINGS. USE FIGURED DIMENSIONS ONLY. CHECK AND VERIFY DIMENSIONS AND LEVELS PRIOR TO THE COMMENCEMENT OF ANY WORK. ALL DISCREPANCIES TO BE REPORTED TO THE DRAFTING OFFICE.

652354

REFER TO SHEET 1 (COVER SHEET) FOR ALL BUILDING INFORMATION REGARDING:

- SUSTAINABILITY REQUIREMENTS
- SITE CLASSIFICATION
- GENERAL BUILDING INFORMATION

ALL MECHANICAL VENTILATION TO BE DISCHARGED TO OUTDOOR AIR AS PER NCC 2022 REQUIREMENTS

FIRE RESISTANT PLASTERBOARD TO BE INSTALLED BEHIND COOKTOP

ALL EXTERIOR STEPS AND LANDINGS BY BUILDER UNLESS NOTED OTHERWISE

ALL GROUND FLOOR BULKHEAD AND SQUARE SET OPENING FRAMES TO BE 2155 ABOVE FFL UNLESS NOTED OTHERWISE

ALL GROUND FLOOR INTERNAL DOORS TO BE 2040 HIGH UNLESS NOTED OTHERWISE

REFER TO WINDOW AND DOOR SCHEDULES FOR FULL DETAILS OF ALL WINDOWS AND DOORS. PLEASE NOTE WINDOW AND DOOR SIZES ARE BASED ON MANUFACTURERS SPECIFICATIONS AT DEPOSIT STAGE AND MAY DIFFER SLIGHTLY TO THE SIZES NOMINATED IN THE SCOPE OF WORKS DUE TO MANUFACTURING CHANGES AT THE TIME OF CONSTRUCTION.

FINAL WINDOW AND EXTERIOR DOOR LOCATIONS MAY BE ADJUSTED ON SITE TO SUIT BRICKWORK GAUGE

ALL STAIR TREADS TO PROVIDE A MINIMUM SLIP RESISTANCE TO MEET NCC 2022 REQUIREMENTS







UNLESS NOTED OTHERWISE ALL ROOMS ARE REFERENCED AS FOLLOWS:

A

B

C

D

LEGEND	
HS / WS	HOB SPOUT / WALL SPOUT
	FACE BRICK / COMMON BRICK
	HEBEL
	SOUND INSULATION
AJ	BRICK ARTICULATION JOINT
SDP	STANDARD DOWNPIPE
CDP	CHARGED DOWNPIPE
	EXHAUST FAN
L.B.W	LOAD BEARING WALL
	THIS DOOR OPENS FIRST
	INTERCONNECTED SMOKE ALARM
# UC	LIFT OFF HINGE / UNDERCUT
+	WATER POINT
WP	FRIDGE WATER POINT
GAS	GAS BAYONET

PROVIDE AND INSTALL 3 PHASE REVERSE CYCLE AIR CONDITIONING SYSTEM. NUMBER AND POSITIONING OF OUTLETS AND THE FINAL LOCATION OF THE RETURN AIR GRILLE WILL BE DETERMINED ON SITE BY THE AIR CONDITIONING CONTRACTOR AND IS SUBJECT TO TRUSS LAYOUT AND ANY OTHER CONSTRUCTION CONSTRAINTS.

FRAME MANUFACTURER TO PROVIDE CLEARANCE FOR PASSAGE OF FAN COIL UNIT FROM RETURN AIR OPENING TO FINAL FAN COIL LOCATION.

ANY PART OF THE FASCIA, GUTTERING OR DOWNPIPE THAT IS WITHIN 450mm OF ANY BOUNDARY IS TO BE NON-COMBUSTIBLE IN ACCORDANCE WITH NCC 2022

ALL EXTERIOR SLABS TO BE GRADED BY CONCRETER TO ACHIEVE APPROX. 1:100 FALL TO OUTSIDE EDGE WITH MAXIMUM CROSSFALL OF 30mm OVER ENTIRE SLAB.

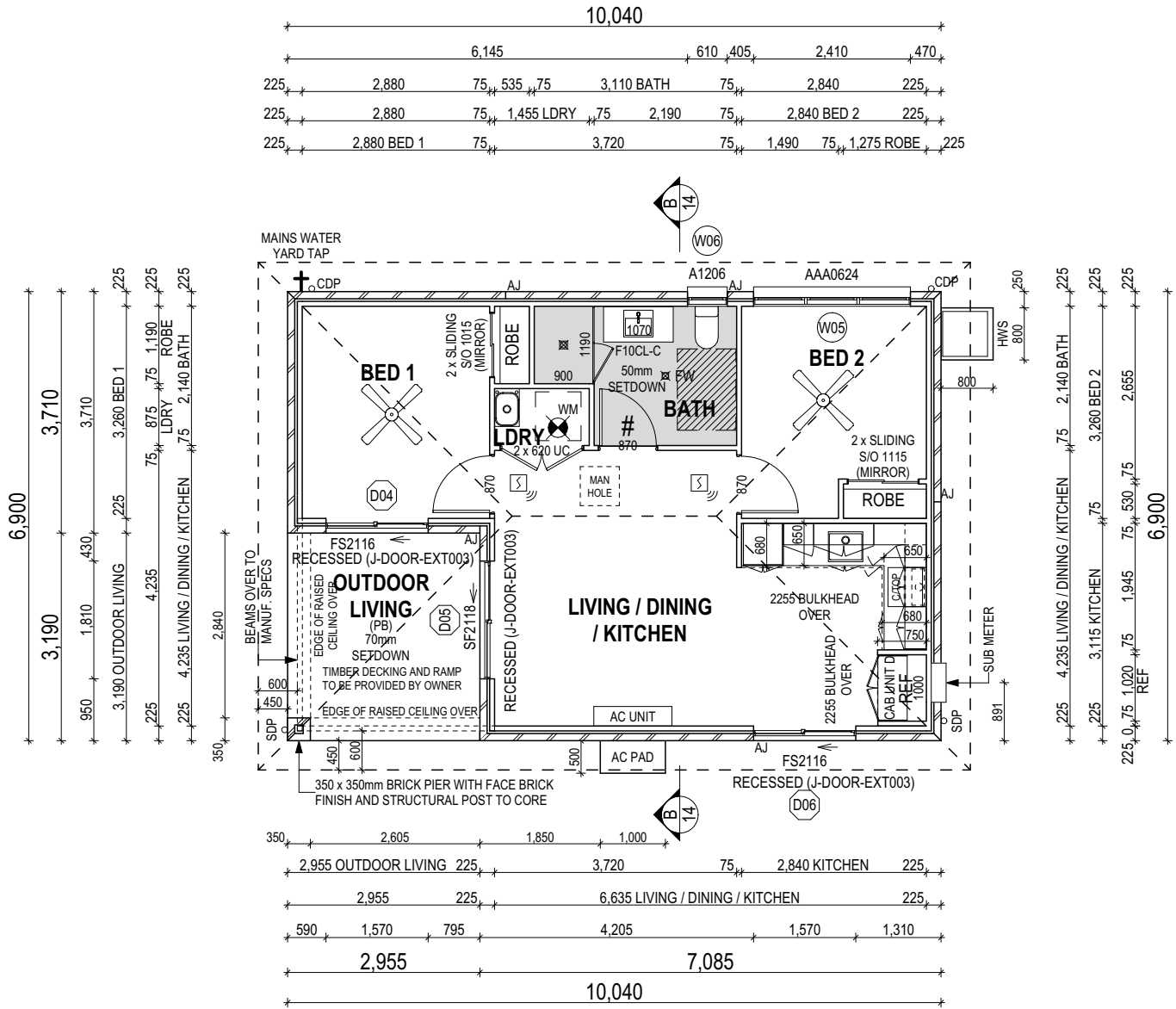

ALL DIMENSIONS ARE FRAME DIMENSIONS

© 2025 MOJO HOMES PTY LTD (ABN 31 166 754 696). THIS DRAWING IS AN ORIGINAL ARTISTIC WORK WITHIN THE MEANING OF THE COPYRIGHT ACT 1968 (CTH). MOJO HOMES PTY LTD IS THE OWNER OF COPYRIGHT IN THIS DRAWING. YOU HEREBY AGREE AND UNDERTAKE THAT YOU WILL NOT IN ANY WAY REPRODUCE, COPY, MODIFY, USE OR TAKE ADVANTAGE OF THE DRAWING TO BUILD A HOUSE BASED ON THIS PLAN (WHETHER IN WHOLE OR IN PART) WITHOUT THE PRIOR WRITTEN CONSENT OF MOJO HOMES PTY LTD.



SPECIFICATION:	REVISION			DRAWN		CLIENT:			HOUSE DESIGN:			HOUSE CODE:		DO NOT SCALE DRAWINGS, USE FIGURED DIMENSIONS ONLY. CHECK AND VERIFY DIMENSIONS AND LEVELS PRIOR TO THE COMMENCEMENT OF ANY WORK. ALL DISCREPANCIES TO BE REPORTED TO THE DRAFTING OFFICE.
M-SERIES	4	COLOURS APPLIED		ENG	20/02/2025	N.S.W EXTENSIONS PTY LTD & EDWARD J FITZPATRICK			LIDO 25			H-JMSLDO40DA		
COPYRIGHT:	5	WORKING DRAWINGS CHECK		GBO	09/04/2025	ADDRESS: 22 PYRAMID AVE, PADSTOW NSW 2211			FACADE DESIGN: CUSTOM			FACADE CODE: F-JMSLDO40CSTM01		
© 2025	6	COUNCIL REQUIREMENT AMENDMENT		GBO	05/05/2025									
	7	AMENDED AS PER PCV007		LCS	26/05/2025	LOT / SECTION / DP:		COUNCIL:		SHEET TITLE:		SHEET No.:	SCALES:	
	8	AMENDED AS PER PCV008 & PCV009		GBO	18/05/2025	113 / - / 16258		CANTERBURY BANKSTOWN COUNCIL		GRANNY FLAT FLOOR PLAN		9 / 29	1:100	